

## CERTECH Cat6A UTP RJ-45 Wall Plate Jack

Australian Style, White, 180 Degrees

### FEATURES:

ANSI/TIA 568C.2 Cat.6A channel and permanent link, ISO/IEC 11801 Class EA T568A & B wiring  
UL safety listed  
PoE IEEE802.3bt type 4 100 watts capability  
Power over HDBaseT (POH) up to 100 watts  
IEC60603-7 dimensions and structural reliability complied

### Installing information

AWG: Solid conductors 23AWG / 1 to 26AWG / 1,  
stranded conductors 24AWG / 7 to 26AWG / 7  
Cable OD: 5.5mm to 8.0mm  
Installing tool: Tool-free

### Material & Structure

RJ45 jack conductors: Phosphor bronze with min. 50 micro-inch nickel plating, min. 50 micro-inch gold plating on contact area  
RJ45 jack housing: ABS+PC, UL94V-0  
PCB: FR4, UL94V-0  
IDC terminals: Phosphor bronze with min. 100 micro-inch Tin plating  
IDC housing: PC, UL94V-0  
Wire management cap: PC, UL94V-0



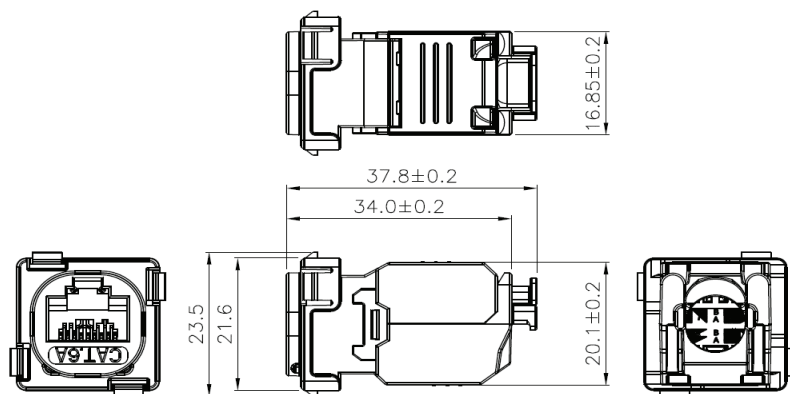

## Mechanical & environmental performance

Jack mating cycles	Max. 750 cycles, RJ45 plug mating and un-mating with the RJ45 jack
Jack insertion force	Max. 20N
Jack retention force	Min. 80N
Installation Temperature	0 to 50°C
Storage Temperature	-20 to 70°C (Under static conditions)
Operation Temperature	-10 to 60°C (Under static conditions)

## Electrical performance

Contact Resistance on Jack side	Max. 20 mohms, initially
Contact Resistance on IDC side	Max. 2 mohms, initially
Conductor Resistance	Max. 200 ohms
Conductor Resistance Unbalance	Max. 50 ohms
Insulation Resistance	Test Voltage 100V-500V DC, min. 500 mega-ohms @20°C
Dielectric Strength	1500 Vdc or 1000 Vac for 60secs
Current Carry Capacity	1.5A @20°C

## NEXT 10 meters Permanent Link

